

of residential lots if they are parked on the driveway or paved areas between the driveway and the nearest side lot line. A second vehicle (including, but not limited to, an automobile, car, truck or RV) may be parked in the following areas if screened by a six (6) foot high fence or wall and if at least one side yard is unobstructed to a width of 36 inches: Areas 1, 2, 3a, 3b, and 4.

For more information on private property parking regulations, please contact City of Dublin Code Enforcement at (925) 833-6610.

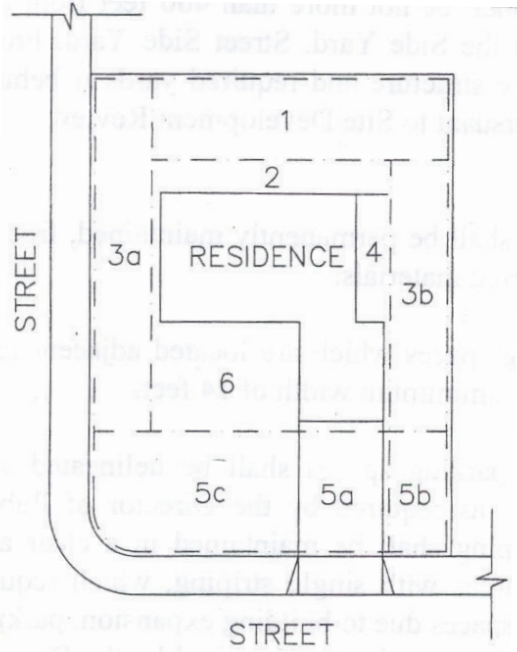

1. Rear Yard
2. Area between Rear Yard and rear of residence
3. Side Yard
 - a. Street Side Yard
 - b. Side Yard
4. Area between Side Yard and side of residence
5. Front Yard
 - a. Driveway
 - b. Area between the driveway and nearest Side Lot Line
 - c. Area between the driveway and the most distant Side Lot Line or Street Side Lot Line
6. Area between Front Yard and front of residence.

Rev. Ord. 28-99 (12/21/99)



DUBLIN
CALIFORNIA

City of Dublin Police Services
6361 Clark Avenue
Dublin, CA 94568
(925) 833-6670 | www.dublin.ca.gov

Rev 10/2020



**OVERSIZED
VEHICLES**



DUBLIN
CALIFORNIA

POLICE SERVICES

A GUIDE TO OVERSIZED VEHICLE PARKING REGULATIONS

VEHICLE RESTRICTIONS

On August 19, 2003, the Dublin City Council adopted the Oversized Vehicle Parking Ordinance (DMC Sec. 6.04.430).

An oversized vehicle is defined as any house car, pickup truck with cab over camper, recreational vehicle or other vehicle that meets or exceeds any of the following criteria:

- Measures more than twenty-two (22) feet in length, OR
- Is more than eighty-four (84) inches in width, OR
- Is more than eighty-four (84) inches in height.

The term “oversized vehicle” does not include a commercial vehicle.

“Non-motorized Vehicle” shall mean any trailer or any other device that is not self-propelled including boat trailers.

No person who owns or has possession, custody or control of any vehicle or non-motorized vehicle which is six (6) feet or more in height (including any load thereon) shall park or leave standing any such vehicle on a street or highway within forty-five (45) feet of any intersection.

THE EXCEPTIONS

The Oversized Motor Vehicle Parking Ordinance states that no person shall, at any time, park or leave standing any “oversized motor vehicle” or “non-motorized vehicle” on any public street, highway or alley except:

- In residential areas, oversized motor vehicles, or non-motorized vehicles which are attached to a motor vehicle or oversized motor vehicle and parked on the street in front of the owner’s residence, are allowed for the purposes of loading, unloading, cleaning, battery-charging, or other activity in preparation or incidental to travel for a period of time not to exceed forty-eight (48) consecutive hours.
- During a state of emergency declared to exist with the City of Dublin by the City Council.

ENFORCEMENT AND FILING A COMPLAINT

Vehicles found in violation of this section may be cited or removed, or both.

The Police Department will only cite/remove non-compliant “oversized vehicles” if a complaint has been filed.

PERMITS FOR TEMPORARY PARKING

The Chief of Police or his designee can grant a permit for an additional twenty-four (24) consecutive hours, but no more than a total of seventy-two (72) hours.

At the end of the permitted period of time, whether forty-eight (48) or seventy-two (72) hours, the vehicle must be removed from its location and shall not be parked on any public street, or posted private property within the city limits, for the purposes stated hereinabove for a period of at least forty-eight (48) hours.

A visitor may temporarily park an “oversized motor vehicle” or a “non-motorized vehicle” attached to a motor vehicle when:

- The visitor obtains a “Visitor Parking Permit” issued by the Dublin Police.
- The vehicle is registered or leased and operated by a person permanently residing more than fifty miles from the visitation site.
- The vehicle may be parked for a period of time not to exceed a total of five days in a thirty-day period.

PARKING ON PRIVATE PROPERTY

The Off-Street Parking Ordinance (DMC Sec. 8.76.060(E)) allows one Recreational Vehicle (RV) to be parked in the front yard